





City of Clearwater Wild, Scenic & Recreational River Classification Map ?-?

Legend

WSR River Classification for Mississippi River

-  River Town
-  Rural Residential
-  Rural Open Space
-  DNR 24K Lakes
-  City Limits

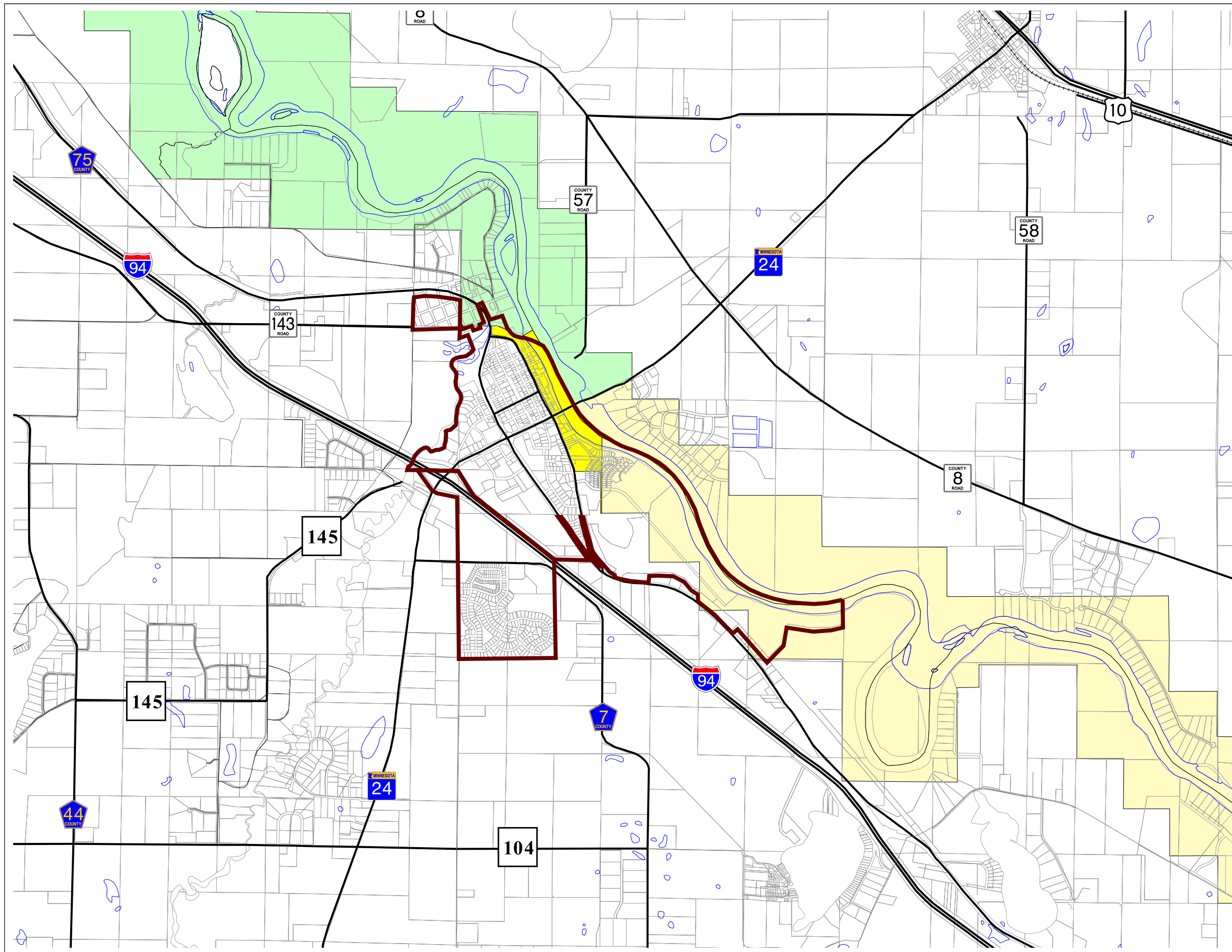

Map/Data Disclaimer:
These map products and all underlying data were developed for use by the city of Clearwater for its internal purposes only, and were not designed or intended for general use by members of the public. This map is neither a legally recorded map nor a survey and is not intended to be used as one. This map is a compilation of records, information and data located in various city, county, state and federal offices and other sources regarding the area shown, and is to be used for reference purposes only. The City does not warrant that the Geographic Information System (GIS) Data used to prepare this map are error free, and the City does not represent that the GIS Data can be used for navigational, tracking or any other purpose requiring exacting measurement of distance or direction or precision in the depiction of geographic features. The preceding disclaimer is provided pursuant to Minnesota Statutes §466.03, Subd. 21(2000), and the user of this map acknowledges that the City shall not be liable for any damages, and expressly waives all claims, and agrees to defend, indemnify, and hold harmless the City from any and all claims brought by User, its employees or agents, or third parties which arise out of the user's access or use of data provided.

Map Date: August 6, 2006

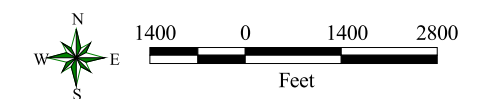

Scale: 1 inch = 2,800 feet
R.F.: 1 : 33,600

